



HT Safe®: Building Drainage Version 2.0.

# Delivery Range 2021

Version February 2021



**Gebr. Ostendorf Kunststoffe GmbH**  
Rudolf-Diesel-Straße 6-8 · D-49377 Vechta  
Tel. +49 (0) 4441 874-10 · Fax +49 (0) 4441 874-15  
verkauf@ostendorf-kunststoffe.com  
www.ostendorf-kunststoffe.com

WHAT YOU CAN COUNT ON:

# Service through and through...

## CONTACT PERSONS

Please visit our website: [www.ostendorf-kunststoffe.com](http://www.ostendorf-kunststoffe.com)

## QUALITY PRODUCTS MADE IN GERMANY



Factory in Vechta



Factory in Emstek



Factory in Rain am Lech

## RELIABLE ORDER PROCESSING



EDI  
Reception of orders

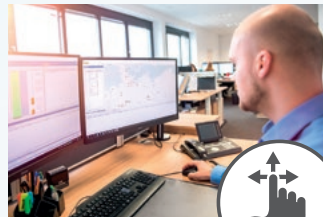

Binding  
delivery dates



Order picking



Transport of goods



## ALSO OFFERED BY OSTENDORF



Premium quality  
for a top price!



Custom solutions  
according to client  
requirements



## DIGITALIZATION

Catalogs on [www.oxomi.de](http://www.oxomi.de) 

Technical product data on [www.itek.de](http://www.itek.de) 

VOB conform tendering on [www.stlb-bau-online.de](http://www.stlb-bau-online.de) 

All tender specifications on [AUSSCHREIBEN.DE](http://AUSSCHREIBEN.DE)

BIM-Revit-Data on [www.mepcontent.com](http://www.mepcontent.com) 

# Material properties HT Safe<sup>®</sup> Sound proof discharge pipes and fittings

## Commercial Name

Ostendorf HT Safe<sup>®</sup>

## Material

Polypropylene (PP)

- hot water resistant
- permanent low inflammability as per DIN 4102 B1

## DIN EN 1451-1

## Application

Drainage within the building structure as

- waste water pipe
- rain water pipe
- ventilation pipe

## Nominal diameters (DN/OD)

32 / 40 / 50 / 75 / 90 / 110 / 125 / 160

## Installation

DIN EN 12056, DIN 1986-100, DIN 4109, VDI 4100

## Colour

Traffic grey B RAL 7043

## Seal

Patented 3 lip seal, factory inlaid SBR lip seal acc. to DIN 681

## Chemical Resistance

Discharge of aggressive media in the range pH2 - pH12  
(see also [www.ostendorf-kunststoffe.com](http://www.ostendorf-kunststoffe.com))

## Marking Pipes and Fittings

Permanent marking with manufacturer label, nominal diameter, DIN standard (DIN EN 1451-1), date of manufacture, material, building material class (fire behavior)  
(Fittings additionally bear information about the nominal angle.)

## Sound Insulation

Measured value 21dB (A)

Sound insulation test according to DIN EN 14366 (Fraunhofer Institute)

<sup>IBP</sup> Noise emission at 4 litres volume flow according to measurement with Bismat 1000 (P-BA 222/2016).

## Central vacuum cleaning system

Test certificate of the State Material Testing Institute Darmstadt

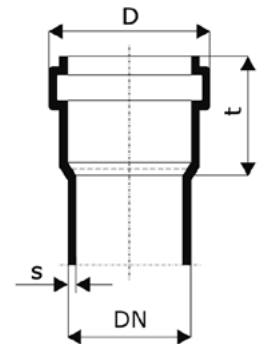

DN/OD	s (mm)	D (mm)	t (mm)
32	1,8	44	40
40	1,8	53	55
50	1,8	63	56
75	1,9	88	61
90	2,2	105	58
110	2,7	125	76
125	3,1	143	82
160	3,9	181	90

*You may find the technical data sheets  
regarding our products on our website:  
[www.ostendorf-kunststoffe.com](http://www.ostendorf-kunststoffe.com)*



### HTsafeEM – Single socket pipe (push-fit)

Part No.	Name	EAN	VPE/Packing	VPE/Pallet
170000	HTsafeEM DN/OD 32 x 150 mm	4052836004284	20	960
170010	HTsafeEM DN/OD 32 x 250 mm	4052836004291	20	800
170020	HTsafeEM DN/OD 32 x 500 mm	4052836004307	20	320
170040	HTsafeEM DN/OD 32 x 1000 mm	4052836004314	10	300
170050	HTsafeEM DN/OD 32 x 1500 mm	4052836004321	10	300
170060	HTsafeEM DN/OD 32 x 2000 mm	4052836004338	10	300
170070	HTsafeEM DN/OD 32 x 3000 mm	4052836004345	10	300
171000	HTsafeEM DN/OD 40 x 150 mm	4052836004475	20	960
171010	HTsafeEM DN/OD 40 x 250 mm	4052836004482	20	960
171020	HTsafeEM DN/OD 40 x 500 mm	4052836004499	20	320
171030	HTsafeEM DN/OD 40 x 750 mm	4052836004505	10	260
171040	HTsafeEM DN/OD 40 x 1000 mm	4052836004512	10	260
171050	HTsafeEM DN/OD 40 x 1500 mm	4052836004529	10	260
171060	HTsafeEM DN/OD 40 x 2000 mm	4052836004536	10	260
171070	HTsafeEM DN/OD 40 x 3000 mm	4052836004543	10	260
172000	HTsafeEM DN/OD 50 x 150 mm	4052836004727	20	720
172010	HTsafeEM DN/OD 50 x 250 mm	4052836004734	20	720
172020	HTsafeEM DN/OD 50 x 500 mm	4052836004741	20	320
172030	HTsafeEM DN/OD 50 x 750 mm	4052836004758	10	200
172040	HTsafeEM DN/OD 50 x 1000 mm	4052836004765	10	200
172050	HTsafeEM DN/OD 50 x 1500 mm	4052836004772	10	200
172060	HTsafeEM DN/OD 50 x 2000 mm	4052836004789	10	200
172070	HTsafeEM DN/OD 50 x 3000 mm	4052836004796	10	200
173000	HTsafeEM DN/OD 75 x 150 mm	4052836005083	20	480
173010	HTsafeEM DN/OD 75 x 250 mm	4052836005090	20	320
173020	HTsafeEM DN/OD 75 x 500 mm	4052836005106	20	160
173030	HTsafeEM DN/OD 75 x 750 mm	4052836005113	6	120
173040	HTsafeEM DN/OD 75 x 1000 mm	4052836005120	6	120
173050	HTsafeEM DN/OD 75 x 1500 mm	4052836005137	6	120
173060	HTsafeEM DN/OD 75 x 2000 mm	4052836005144	6	120
173070	HTsafeEM DN/OD 75 x 3000 mm	4052836005151	6	120

### HTsafeEM – Single socket pipe (push-fit)



Part No.	Name	EAN	VPE/Packing	VPE/Pallet
174000	HTsafeEM DN/OD 90 x 150 mm	4052836005380	20	320
174010	HTsafeEM DN/OD 90 x 250 mm	4052836005397	20	240
174020	HTsafeEM DN/OD 90 x 500 mm	4052836005403	10	120
174030	HTsafeEM DN/OD 90 x 750 mm	4052836005410	4	96
174040	HTsafeEM DN/OD 90 x 1000 mm	4052836005427	4	96
174050	HTsafeEM DN/OD 90 x 1500 mm	4052836005434	4	96
174060	HTsafeEM DN/OD 90 x 2000 mm	4052836005441	4	96
174070	HTsafeEM DN/OD 90 x 3000 mm	4052836005458	4	96
175000	HTsafeEM DN/OD 110 x 150 mm	4052836005670	20	160
175010	HTsafeEM DN/OD 110 x 250 mm	4052836005687	20	160
175020	HTsafeEM DN/OD 110 x 500 mm	4052836005694	10	80
175030	HTsafeEM DN/OD 110 x 750 mm	4052836005700	4	60
175040	HTsafeEM DN/OD 110 x 1000 mm	4052836005717	4	60
175050	HTsafeEM DN/OD 110 x 1500 mm	4052836005724	4	60
175060	HTsafeEM DN/OD 110 x 2000 mm	4052836005731	4	60
175070	HTsafeEM DN/OD 110 x 3000 mm	4052836005748	4	60
176000	HTsafeEM DN/OD 125 x 150 mm	4052836006080	10	120
176010	HTsafeEM DN/OD 125 x 250 mm	4052836006097	10	120
176020	HTsafeEM DN/OD 125 x 500 mm	4052836006103	5	60
176030	HTsafeEM DN/OD 125 x 750 mm	4052836006110	1	54
176040	HTsafeEM DN/OD 125 x 1000 mm	4052836006127	1	54
176050	HTsafeEM DN/OD 125 x 1500 mm	4052836006134	1	54
176060	HTsafeEM DN/OD 125 x 2000 mm	4052836006141	1	54
176070	HTsafeEM DN/OD 125 x 3000 mm	4052836006158	1	54
177000	HTsafeEM DN/OD 160 x 150 mm	4052836006301	1	84
177010	HTsafeEM DN/OD 160 x 250 mm	4052836006318	1	56
177020	HTsafeEM DN/OD 160 x 500 mm	4052836006325	1	35
177030	HTsafeEM DN/OD 160 x 750 mm	4052836006332	1	35
177040	HTsafeEM DN/OD 160 x 1000 mm	4052836006349	1	35
177050	HTsafeEM DN/OD 160 x 1500 mm	4052836006356	1	35
177060	HTsafeEM DN/OD 160 x 2000 mm	4052836006363	1	35
177070	HTsafeEM DN/OD 160 x 3000 mm	4052836006370	1	35

## HTsafeDM – Double socket pipe



Part No.	Name	EAN	VPE/Packing	VPE/Pallet
178020	HTsafeDM DN/OD 32 x 500 mm	4052836088901	20	320
178040	HTsafeDM DN/OD 32 x 1000 mm	4052836088932	10	300
178050	HTsafeDM DN/OD 32 x 1500 mm	4052836088963	10	300
178060	HTsafeDM DN/OD 32 x 2000 mm	4052836088994	10	300
178070	HTsafeDM DN/OD 32 x 3000 mm	4052836089021	10	300
178120	HTsafeDM DN/OD 40 x 500 mm	4052836089052	20	240
178140	HTsafeDM DN/OD 40 x 1000 mm	4052836089083	10	240
178150	HTsafeDM DN/OD 40 x 1500 mm	4052836089113	10	240
178160	HTsafeDM DN/OD 40 x 2000 mm	4052836089144	10	240
178170	HTsafeDM DN/OD 40 x 3000 mm	4052836089175	10	240
178220	HTsafeDM DN/OD 50 x 500 mm	4052836089205	20	240
178240	HTsafeDM DN/OD 50 x 1000 mm	4052836089236	10	200
178250	HTsafeDM DN/OD 50 x 1500 mm	4052836089267	10	200
178260	HTsafeDM DN/OD 50 x 2000 mm	4052836089298	10	200
178270	HTsafeDM DN/OD 50 x 3000 mm	4052836089328	10	200
178320	HTsafeDM DN/OD 75 x 500 mm	4052836089359	10	120
178340	HTsafeDM DN/OD 75 x 1000 mm	4052836089380	1	104
178350	HTsafeDM DN/OD 75 x 1500 mm	4052836089403	1	104
178360	HTsafeDM DN/OD 75 x 2000 mm	4052836089427	1	104
178370	HTsafeDM DN/OD 75 x 3000 mm	4052836089441	1	104
178420	HTsafeDM DN/OD 90 x 500 mm	4052836089465	10	90
178440	HTsafeDM DN/OD 90 x 1000 mm	4052836089496	4	96
178450	HTsafeDM DN/OD 90 x 1500 mm	4052836089526	4	96
178460	HTsafeDM DN/OD 90 x 2000 mm	4052836089557	4	96
178470	HTsafeDM DN/OD 90 x 3000 mm	4052836089588	4	96
178520	HTsafeDM DN/OD 110 x 500 mm	4052836089618	6	54
178540	HTsafeDM DN/OD 110 x 1000 mm	4052836089649	1	54
178550	HTsafeDM DN/OD 110 x 1500 mm	4052836089663	1	54
178560	HTsafeDM DN/OD 110 x 2000 mm	4052836089687	1	54
178570	HTsafeDM DN/OD 110 x 3000 mm	4052836089700	1	54
178620	HTsafeDM DN/OD 125 x 500 mm	4052836089724	1	48
178640	HTsafeDM DN/OD 125 x 1000 mm	4052836089748	4	48
178650	HTsafeDM DN/OD 125 x 1500 mm	4052836089779	4	48
178660	HTsafeDM DN/OD 125 x 2000 mm	4052836089809	4	48
178670	HTsafeDM DN/OD 125 x 3000 mm	4052836089830	1	48

## HTsafeGL – Plain ended pipe without sleeve



Part No.	Name	EAN	VPE/Packing	VPE/Pallet
170080	HTsafeGL DN/OD 32 x 5000 mm	4052836004352	1	300
171080	HTsafeGL DN/OD 40 x 5000 mm	4052836004550	1	260
172080	HTsafeGL DN/OD 50 x 5000 mm	4052836004802	1	200
173080	HTsafeGL DN/OD 75 x 5000 mm	4052836005168	1	120
174080	HTsafeGL DN/OD 90 x 5000 mm	4052836005465	1	96
175080	HTsafeGL DN/OD 110 x 5000 mm	4052836005755	1	60
176080	HTsafeGL DN/OD 125 x 5000 mm	4052836006165	1	54
177080	HTsafeGL DN/OD 160 x 5000 mm	4052836006387	1	35

## HTsafeB – Bend



15 Degrees



30 Degrees

Part No.	Name	EAN	VPE/ Cardboard Box	VPE/Pallet
170100	HTsafeB Bend DN/OD 32 15 Degrees	4052836004369	20	1400
170110	HTsafeB Bend DN/OD 32 30 Degrees	4052836004376	20	1400
170120	HTsafeB Bend DN/OD 32 45 Degrees	4052836004383	20	1400
170130	HTsafeB Bend DN/OD 32 67,5 Degrees	4052836004390	20	1400
170140	HTsafeB Bend DN/OD 32 87,5 Degrees	4052836004406	20	1400
171100	HTsafeB Bend DN/OD 40 15 Degrees	4052836004567	20	960
171110	HTsafeB Bend DN/OD 40 30 Degrees	4052836004574	20	960
171120	HTsafeB Bend DN/OD 40 45 Degrees	4052836004581	20	960
171130	HTsafeB Bend DN/OD 40 67,5 Degrees	4052836004598	20	960
171140	HTsafeB Bend DN/OD 40 87,5 Degrees	4052836004604	20	960
172100	HTsafeB Bend DN/OD 50 15 Degrees	4052836004819	20	960
172110	HTsafeB Bend DN/OD 50 30 Degrees	4052836004826	20	960
172120	HTsafeB Bend DN/OD 50 45 Degrees	4052836004833	20	960
172130	HTsafeB Bend DN/OD 50 67,5 Degrees	4052836004840	20	960
172140	HTsafeB Bend DN/OD 50 87,5 Degrees	4052836004857	20	960



45 Degrees



67,5 Degrees



87,5 Degrees

## HTsafeB – Bend

Part No.	Name	EAN	VPE/ Cardboard Box	VPE/Pallet
173100	HTsafeB Bend DN/OD 75 15 Degrees	4052836005175	20	480
173110	HTsafeB Bend DN/OD 75 30 Degrees	4052836005182	20	480
173120	HTsafeB Bend DN/OD 75 45 Degrees	4052836005199	20	480
173130	HTsafeB Bend DN/OD 75 67,5 Degrees	4052836005205	20	480
173140	HTsafeB Bend DN/OD 75 87,5 Degrees	4052836005212	20	480
174100	HTsafeB Bend DN/OD 90 15 Degrees	4052836005472	20	400
174110	HTsafeB Bend DN/OD 90 30 Degrees	4052836005489	20	400
174120	HTsafeB Bend DN/OD 90 45 Degrees	4052836005496	20	400
174130	HTsafeB Bend DN/OD 90 67,5 Degrees	4052836005502	20	240
174140	HTsafeB Bend DN/OD 90 87,5 Degrees	4052836005519	20	240
175100	HTsafeB Bend DN/OD 110 15 Degrees	4052836005762	20	240
175110	HTsafeB Bend DN/OD 110 30 Degrees	4052836005779	20	240
175120	HTsafeB Bend DN/OD 110 45 Degrees	4052836005786	20	240
175130	HTsafeB Bend DN/OD 110 67,5 Degrees	4052836005793	20	160
175140	HTsafeB Bend DN/OD 110 87,5 Degrees	4052836005809	20	160
176100	HTsafeB Bend DN/OD 125 15 Degrees	4052836006172	20	160
176110	HTsafeB Bend DN/OD 125 30 Degrees	4052836006189	20	160
176120	HTsafeB Bend DN/OD 125 45 Degrees	4052836006196	20	160
176140	HTsafeB Bend DN/OD 125 87,5 Degrees	4052836006202	10	120
177100	HTsafeB Bend DN/OD 160 15 Degrees	4052836006394	10	80
177110	HTsafeB Bend DN/OD 160 30 Degrees	4052836006400	10	80
177120	HTsafeB Bend DN/OD 160 45 Degrees	4052836006417	5	60
177140	HTsafeB Bend DN/OD 160 87,5 Degrees	4052836006424	5	60



### HTsafeEA – Branch



45 Degrees

Part No.	Name	EAN	VPE/ Cardboard Box	VPE/Pallet
170200	HTsafeEA Branch DN/OD 32/32 45 Degrees	4052836004413	20	960
170300	HTsafeEA Branch DN/OD 32/32 67,5 Degrees	4052836004420	20	960
170400	HTsafeEA Branch DN/OD 32/32 87,5 Degrees	4052836004437	20	960

171200	HTsafeEA Branch DN/OD 40/40 45 Degrees	4052836004611	20	960
171300	HTsafeEA Branch DN/OD 40/40 67,5 Degrees	4052836004628	20	960
171400	HTsafeEA Branch DN/OD 40/40 87,5 Degrees	4052836004635	20	960

172210	HTsafeEA Branch DN/OD 50/40 45 Degrees	4052836004871	20	480
172200	HTsafeEA Branch DN/OD 50/50 45 Degrees	4052836004864	20	480
172310	HTsafeEA Branch DN/OD 50/40 67,5 Degrees	4052836004895	20	480
172300	HTsafeEA Branch DN/OD 50/50 67,5 Degrees	4052836004888	20	480
172410	HTsafeEA Branch DN/OD 50/40 87,5 Degrees	4052836004918	20	480
172400	HTsafeEA Branch DN/OD 50/50 87,5 Degrees	4052836004901	20	480

173210	HTsafeEA Branch DN/OD 75/50 45 Degrees	4052836005236	20	400
173200	HTsafeEA Branch DN/OD 75/75 45 Degrees	4052836005229	20	240
173310	HTsafeEA Branch DN/OD 75/50 67,5 Degrees	4052836005250	20	480
173300	HTsafeEA Branch DN/OD 75/75 67,5 Degrees	4052836005243	20	240
173410	HTsafeEA Branch DN/OD 75/50 87,5 Degrees	4052836005274	20	400
173400	HTsafeEA Branch DN/OD 75/75 87,5 Degrees	4052836005267	20	240

174220	HTsafeEA Branch DN/OD 90/50 45 Degrees	4052836005540	20	240
174210	HTsafeEA Branch DN/OD 90/75 45 Degrees	4052836005533	20	240
174200	HTsafeEA Branch DN/OD 90/90 45 Degrees	4052836005526	20	160
174420	HTsafeEA Branch DN/OD 90/50 87,5 Degrees	4052836005571	20	240
174410	HTsafeEA Branch DN/OD 90/75 87,5 Degrees	4052836005564	20	240
174400	HTsafeEA Branch DN/OD 90/90 87,5 Degrees	4052836005557	20	160



67,5 Degrees



87,5 Degrees

## HTsafeEA – Branch

Part No.	Name	EAN	VPE/ Cardboard Box	VPE/Pallet	
175220	HTsafeEA Branch DN/OD 110/50 45 Degrees	4052836005830	20	240	
175210	HTsafeEA Branch DN/OD 110/75 45 Degrees	4052836005823	20	160	
175200	HTsafeEA Branch DN/OD 110/110 45 Degrees	4052836005816	8	96	
175320	HTsafeEA Branch DN/OD 110/50 67,5 Degrees	4052836005861	20	240	
175310	HTsafeEA Branch DN/OD 110/75 67,5 Degrees	4052836005854	20	160	
175300	HTsafeEA Branch DN/OD 110/110 67,5 Degrees	4052836005847	10	120	
175420	HTsafeEA Branch DN/OD 110/50 87,5 Degrees	4052836005885	20	240	
175410	HTsafeEA Branch DN/OD 110/75 87,5 Degrees	4052836005878	20	160	
175400	HTsafeEA Branch DN/OD 110/110 87,5 Degrees	4052836008787	8	96	Unit changed!
176210	HTsafeEA Branch DN/OD 125/110 45 Degrees	4052836006226	5	60	
176200	HTsafeEA Branch DN/OD 125/125 45 Degrees	4052836006219	5	60	
176410	HTsafeEA Branch DN/OD 125/110 87,5 Degrees	4052836006240	5	60	
176400	HTsafeEA Branch DN/OD 125/125 87,5 Degrees	4052836006233	5	60	
177210	HTsafeEA Branch DN/OD 160/110 45 Degrees	4052836006448	5	40	
177200	HTsafeEA Branch DN/OD 160/160 45 Degrees	4052836006431	4	32	
177410	HTsafeEA Branch DN/OD 160/110 87,5 Degrees	4052836006462	5	60	
177400	HTsafeEA Branch DN/OD 160/160 87,5 Degrees	4052836006455	4	48	



## HTsafeDA – Double Branch

Part No.	Name	EAN	VPE/ Cardboard Box	VPE/Pallet	
172900	HTsafeDA Double Branch DN/OD 50/50/50 67,5 Degrees	4052836005021	20	480	
173900	HTsafeDA Double Branch DN/OD 75/75/75 67,5 Degrees	4052836005373	20	240	
174900	HTsafeDA Double Branch DN/OD 90/90/90 87,5 Degrees (swept)*	4052836005663	8	96	Unit changed!
175910	HTsafeDA Double Branch DN/OD 110/50/50 67,5 Degrees	4052836006066	10	120	
175900	HTsafeDA Double Branch DN/OD 110/110/110 67,5 Degrees	4052836006059	5	60	
175930	HTsafeDA Double Branch DN/OD 110/110/110 87,5 Degrees (swept)*	4052836136022	5	60	NEW!

\*with improved branch design for a better flow



## HTsafeSA – Plug-in branch

Part No.	Name	EAN	VPE/ Cardboard Box	VPE/Pallet	
175740	HTsafeSA Plug-in branch DN/OD 110/110 87,5 Degrees	4052836135711	8	96	NEW!



## HTsafeDSW – Double Connection Bend

Part No.	Name	EAN	VPE/ Cardboard Box	VPE/Pallet
172970	HTsafeDSW Double Connection Bend DN/OD 40/50/40	4052836005076	20	480



## HTsafeED – Corner Double Branch

Part No.	Name	EAN	VPE/ Cardboard Box	VPE/Pallet
175920	HTsafeED Corner Double Branch DN/OD 110/110/110 67,5 Degrees	4052836006073	10	80



## HTsafeU – Coupler

Part No.	Name	EAN	VPE/ Cardboard Box	VPE/Pallet
170500	HTsafeU Coupler DN/OD 32	4052836004444	20	1400
171500	HTsafeU Coupler DN/OD 40	4052836004642	20	960
172500	HTsafeU Coupler DN/OD 50	4052836004925	20	960
173500	HTsafeU Coupler DN/OD 75	4052836005281	20	480
174500	HTsafeU Coupler DN/OD 90	4052836005588	20	480
175500	HTsafeU Coupler DN/OD 110	4052836005892	20	240
176500	HTsafeU Coupler DN/OD 125	4052836006257	20	160
177500	HTsafeU Coupler DN/OD 160	4052836006479	15	120



## Skolan Safe – Connection to HT Safe

Part No.	Name	EAN	VPE/ Cardboard Box	VPE/Pallet
333830	SKOLANsafe Connection to HT Safe DN/OD 75	4052836338303	20	480
336820	SKOLANsafe Connection to HT Safe/KG DN/OD 125	4052836368201	4	160

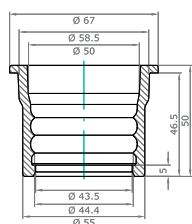

## Skolan Safe – Transition sleeve

Part No.	Name	EAN	VPE/ Cardboard Box	VPE/Pallet
910833	SKOLANsafe Transition sleeve Skolan Safe 58 / HT Safe 50 mm	4052836086754	20	2560



### HTsafeUG – Connection piece to cast-iron pipe

Part No.	Name	EAN	VPE/ Cardboard Box	VPE/Pallet
172820	HTsafeUG Connection piece to cast-iron pipe DN/OD 50	4052836005014	20	960
173820	HTsafeUG Connection piece to cast-iron pipe DN/OD 75	4052836005366	20	480
175820	HTsafeUG Connection piece to cast-iron pipe DN/OD 110	4052836006042	20	480



### HTsafeM – Plug

Part No.	Name	EAN	VPE/ Cardboard Box	VPE/Pallet
170620	HTsafeM Plug DN/OD 32	4052836004468	100	7000
171620	HTsafeM Plug DN/OD 40	4052836004666	20	2880
172620	HTsafeM Plug DN/OD 50	4052836004956	20	2880
173620	HTsafeM Plug DN/OD 75	4052836005311	20	2560
174620	HTsafeM Plug DN/OD 90	4052836005618	20	960
175620	HTsafeM Plug DN/OD 110	4052836005922	20	960
176620	HTsafeM Plug DN/OD 125	4052836006288	20	480
177620	HTsafeM Plug DN/OD 160	4052836006509	20	480



### HTsafeMM – Double socket

Part No.	Name	EAN	VPE/ Cardboard Box	VPE/Pallet
170510	HTsafeMM Double socket DN/OD 32	4052836004451	20	1400
171510	HTsafeMM Double socket DN/OD 40	4052836004659	20	960
172510	HTsafeMM Double socket DN/OD 50	4052836004932	20	960
173510	HTsafeMM Double socket DN/OD 75	4052836005298	20	480
174510	HTsafeMM Double socket DN/OD 90	4052836005595	20	480
175510	HTsafeMM Double socket DN/OD 110	4052836005908	20	240
176510	HTsafeMM Double socket DN/OD 125	4052836006264	20	160
177510	HTsafeMM Double socket DN/OD 160	4052836006486	15	120

### HTsafeR – Reducer, eccentric



Part No.	Name	EAN	VPE/ Cardboard Box	VPE/Pallet
171710	HTsafeR Reducer DN/OD 40/32	4052836004673	20	1400
172720	HTsafeR Reducer DN/OD 50/32	4052836004987	20	960
172710	HTsafeR Reducer DN/OD 50/40	4052836004963	20	960
173710	HTsafeR Reducer DN/OD 75/50	4052836005328	12	576
174720	HTsafeR Reducer DN/OD 90/50	4052836005632	20	480
174710	HTsafeR Reducer DN/OD 90/75	4052836005625	20	480
175720	HTsafeR Reducer DN/OD 110/50	4052836005977	20	400
175710	HTsafeR Reducer DN/OD 110/75	4052836005953	20	480
175700	HTsafeR Reducer DN/OD 110/90	4052836005939	20	240
176710	HTsafeR Reducer DN/OD 125/110	4052836006295	20	240
177710	HTsafeR Reducer DN/OD 160/110	4052836006523	20	160
177700	HTsafeR Reducer DN/OD 160/125	4052836006516	20	160

Unit  
changed!

### HTsafeR – Reducer, short



Part No.	Name	EAN	VPE/ Cardboard Box	VPE/Pallet
172715	HTsafeR Reducer DN/OD 50/40 Short Version	4052836004970	20	1400
173715	HTsafeR Reducer DN/OD 75/50 Short Version	4052836005335	20	960
174730	HTsafeR Reducer DN/OD 90/50 Short Version	4052836005649	20	480
175725	HTsafeR Reducer DN/OD 110/50 Short Version	4052836005984	20	480
175715	HTsafeR Reducer DN/OD 110/75 Short Version	4052836005960	20	480
175705	HTsafeR Reducer DN/OD 110/90 Short Version	4052836005946	20	480

### HTsafeRE – Cleaning Pipe



Part No.	Name	EAN	VPE/ Cardboard Box	VPE/Pallet
172600	HTsafeRE Cleaning Pipe DN/OD 50	4052836004949	20	480
173600	HTsafeRE Cleaning Pipe DN/OD 75	4052836005304	20	480
174600	HTsafeRE Cleaning Pipe DN/OD 90	4052836005601	20	240
175600	HTsafeRE Cleaning Pipe DN/OD 110	4052836005915	20	160
176600	HTsafeRE Cleaning Pipe DN/OD 125	4052836006271	5	60
177600	HTsafeRE Cleaning Pipe DN/OD 160	4052836006493	5	60



## HTsafeRI – Inner reducer

Part No.	Name	EAN	VPE/ Cardboard Box	VPE/Pallet
175770	HTsafeRI Inner reducer DN/OD 110/50	4052836006011	20	960
175760	HTsafeRI Inner reducer DN/OD 110/75	4052836006004	20	480



## HTsafeL – Long socket

Part No.	Name	EAN	VPE/ Cardboard Box	VPE/Pallet
171800	HTsafeL Long socket DN/OD 40	4052836004680	20	960
172800	HTsafeL Long socket DN/OD 50	4052836004994	20	480
173800	HTsafeL Long socket DN/OD 75	4052836005342	20	480
174800	HTsafeL Long socket DN/OD 90	4052836005656	20	240
175800	HTsafeL Long socket DN/OD 110	4052836006028	20	160



## HTsafeS – Siphon connection piece to metal and plastic

Part No.	Name	EAN	VPE/ Cardboard Box	VPE/Pallet
171900	HTsafeS Siphon connection piece to metal and plastic DN/OD 40/40	4052836004697	20	2880
172910	HTsafeS Siphon connection piece to metal and plastic DN/OD 50/40	4052836005038	20	2880
172920	HTsafeS Siphon connection piece to metal and plastic DN/OD 50/50	4052836005045	20	960



## HTsafeSW – Angled siphon connection piece to metal and plastic

Part No.	Name	EAN	VPE/ Cardboard Box	VPE/Pallet
171910	HTsafeSW Angled siphon connection piece to metal and plastic DN/OD 40/30	4052836004703	20	960
171920	HTsafeSW Angled siphon connection piece to metal and plastic DN/OD 40/40	4052836004710	20	960
172940	HTsafeSW Angled siphon connection piece to metal and plastic DN/OD 50/40	4052836005052	20	960
172950	HTsafeSW Angled siphon connection piece to metal and plastic DN/OD 50/50	4052836005069	20	960



## HTsafeSM – Plug-in socket

Part No.	Name	EAN	VPE/ Cardboard Box	VPE/Pallet
175750	HTsafeSM Plug-in socket DN/OD 110/110	4052836005991	36	288



### HTsafeAM – Single socket

Part No.	Name	EAN	VPE/ Cardboard Box	VPE/Pallet
172810	HTsafeAM Single socket DN/OD 50	4052836005007	20	480
173810	HTsafeAM Single socket DN/OD 75	4052836005359	20	480
175810	HTsafeAM Single socket DN/OD 110	4052836006035	20	240



### HT Safe® – Replacement Lip seal SBR

Part No.	Name	EAN	VPE/ Cardboard Box	VPE/Pallet
880007	Replacement Lip seal SBR DN/OD 32 (HT Safe)	4052836003928	-	-
880017	Replacement Lip seal SBR DN/OD 40 (HT Safe)	4052836003942	-	-
880027	Replacement Lip seal SBR DN/OD 50 (HT Safe)	4052836003966	-	-
880037	Replacement Lip seal SBR DN/OD 75 (HT Safe)	4052836003980	-	-
880047	Replacement Lip seal SBR DN/OD 90 (HT Safe/Skolan Safe)	4052836003768	-	-
880057	Replacement Lip seal SBR DN/OD 110 (HT Safe)	4052836800558	-	-
880077	Replacement Lip seal SBR DN/OD 125 (HT Safe)	4052836004000	-	-
880087	Replacement Lip seal SBR DN/OD 160 (HT Safe)	4052836004024	-	-



### HT Safe® – Replacement Lip seal NBR (resistant against oils)

Part No.	Name	EAN	VPE/ Cardboard Box	VPE/Pallet
880217	Replacement Lip seal NBR DN/OD 40 (HT Safe)	4052836004048	-	-
880227	Replacement Lip seal NBR DN/OD 50 (HT Safe)	4052836004062	-	-
880237	Replacement Lip seal NBR DN/OD 75 (HT Safe)	4052836004086	-	-
880247	Replacement Lip seal NBR DN/OD 90 (HT Safe, Skolan Safe)	4052836004109	-	-
880260	Replacement Lip seal NBR DN/OD 110 (KG PVC SN 4, Skolan Safe fitting, HT Safe)	4052836802606	-	-
880275	Replacement Lip seal NBR DN/OD 125 (KG PVC SN 4, HT Safe)	4052836004147	-	-
880290	Replacement Lip seal NBR DN/OD 160 (KG PVC SN4, HT Safe)	4052836004161	-	-



## HTsafeGA – Gasket

Part No.	Name	EAN	VPE/ Cardboard Box	VPE/Pallet
881005	GA Gasket DN/OD 50	4052836810052	36	-
881015	GA Gasket DN/OD 75	4052836810151	30	-
881025	GA Gasket DN/OD 110	4052836810250	16	-



## HTsafeGM – Gasket for siphon bend

Part No.	Name	EAN	VPE/ Cardboard Box	VPE/Pallet
881200	HTGM Gasket for siphon bend DN/OD 40/30 A	4052836812001	20	-
881210	HTGM Gasket for siphon bend DN/OD 40/30 B	4052836812100	20	-
881220	HTGM Gasket for siphon bend DN/OD 40/40 C	4052836812209	20	-
881230	HTGM Gasket for siphon bend DN/OD 40/50/1 1/4	4052836812308	20	-
881240	HTGM Gasket for siphon bend DN/OD 50/30 D	4052836812407	20	-
881250	HTGM Gasket for siphon bend DN/OD 50/40 E	4052836812506	20	-
881260	HTGM Gasket for siphon bend DN/OD 50/50 F	4052836812605	20	-

Part No.	Name	Suitable for	Metal pipe Ø
881200	HTsafeGM Gasket for siphon bend DN/OD 40/30 A	HTsafeSW 40/30 (Part No. 171910)	28 – 34 mm
881210	HTsafeGM Gasket for siphon bend DN/OD 40/30 B	HTsafeS 40/40 (Part No. 171900) HTsafeS 50/40 (Part No. 172910) HTsafeSW 40/40 (Part No. 171920) HTsafeSW 50/40 (Part No. 172940) HTsafeDSW 40/50/40 (Part No. 172970)	28 – 34 mm
881220	HTsafeGM Gasket for siphon bend DN/OD 40/40 C	HTsafeS 40/40 (Part No. 171900) HTsafeS 50/40 (Part No. 172910) HTsafeSW 40/40 (Part No. 171920) HTsafeSW 50/40 (Part No. 172940) HTsafeDSW 40/50/40 (Part No. 172970)	38 – 44 mm
881230	HTsafeGM Gasket for siphon bend DN/OD 40/50/1 1/4	For all pipes and fittings with spigot end DN/OD 50	28 – 30 mm
881240	HTsafeGM Gasket for siphon bend DN/OD 50/30 D	HTsafeS 50/50 (Part No. 172920) HTsafeSW 50/50 (Part No. 172950)	28 – 34 mm
881250	HTsafeGM Gasket for siphon bend DN/OD 50/40 E	HTsafeS 50/50 (Part No. 172920) HTsafeSW 50/50 (Part No. 172950)	38 – 44 mm
881260	HTsafeGM Gasket for siphon bend DN/OD 50/50 F	HTsafeS 50/50 (Part No. 172920) HTsafeSW 50/50 (Part No. 172950)	48 – 54 mm



## HT Safe® – Pull-out Protection



Part No.	Name	EAN	VPE/ Cardboard Box	VPE/Pallet
881590	Pull-out Protection DN/OD 32	4052836098474	18	-
881595	Pull-out Protection DN/OD 40	4052836098504	14	-
881500	Pull-out Protection DN/OD 50	4052836815002	50	-
881510	Pull-out Protection DN/OD 75	4052836815101	30	-
881520	Pull-out Protection DN/OD 90	4052836815200	20	-
881535	Pull-out Protection DN/OD 110	4052836086808	26	-
881540	Pull-out Protection DN/OD 125	4052836815408	15	-
881580	Pull-out Protection DN/OD 160	4052836815804	10	-

## HT Safe® – Lubricant



Part No.	Name	EAN	VPE/ Cardboard Box	VPE/Pallet
881800	Lubricant 150 ml	4052836818003	50	-
881810	Lubricant 250 ml	4052836818102	50	-
881820	Lubricant 500 ml	4052836818201	24	-
881830	Lubricant 1.000 ml	4052836818300	12	-
881840	Lubricant 3.000 ml bucket	4052836123749	1	-

## HT Safe® – Rubber nipple for metal pipes



Part No.	Name	EAN	VPE/ Cardboard Box	VPE/Pallet
881309-07	Rubber nipple for metal pipes DN/OD 40 1 1/4"	4025075007415	30	-
881319-07	Rubber nipple for metal pipes DN/OD 50 1 1/2"	4050463100737	30	-
881329-07	Rubber nipple for metal pipes DN/OD 50 1 1/4"	4050463100720	30	-

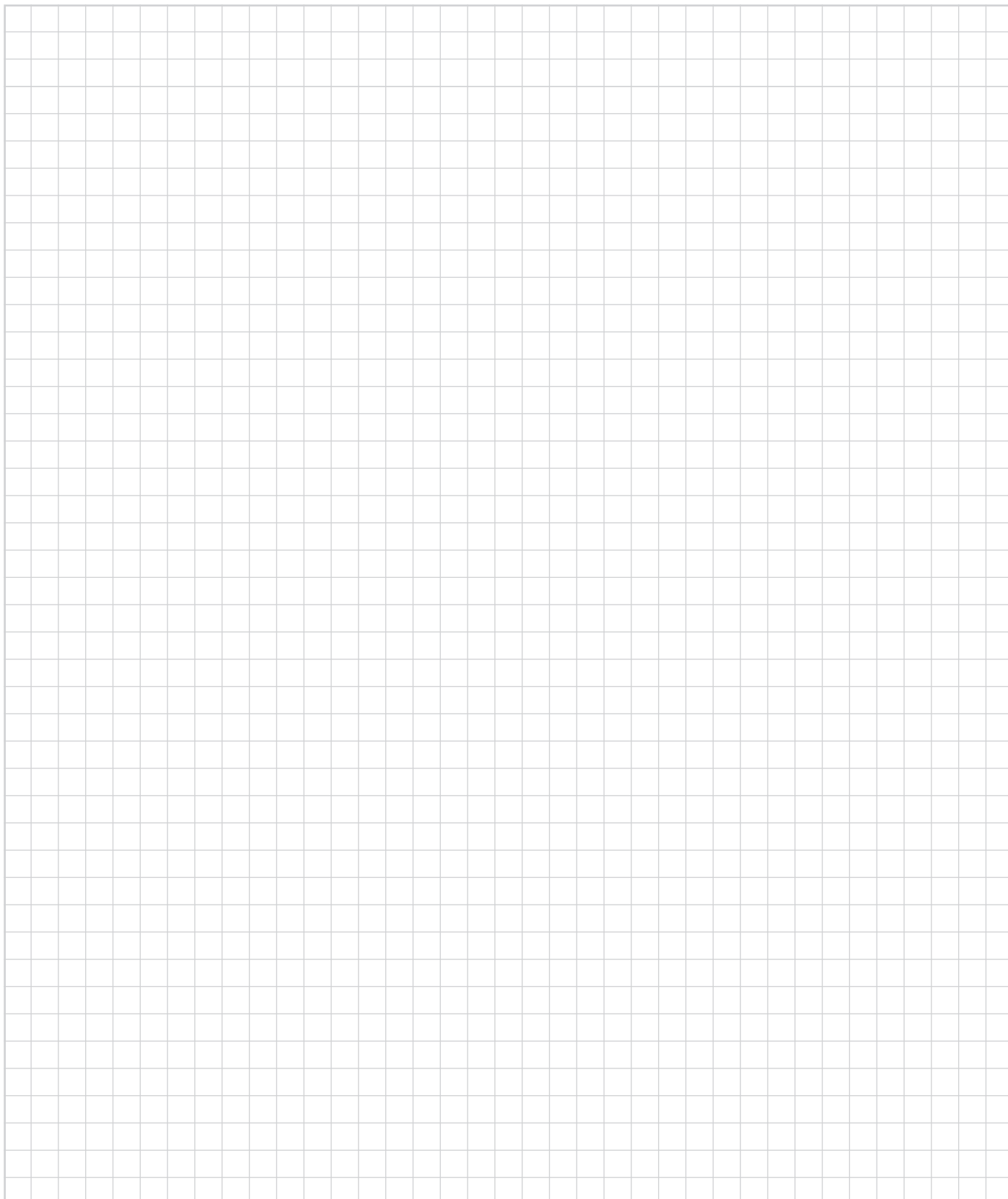

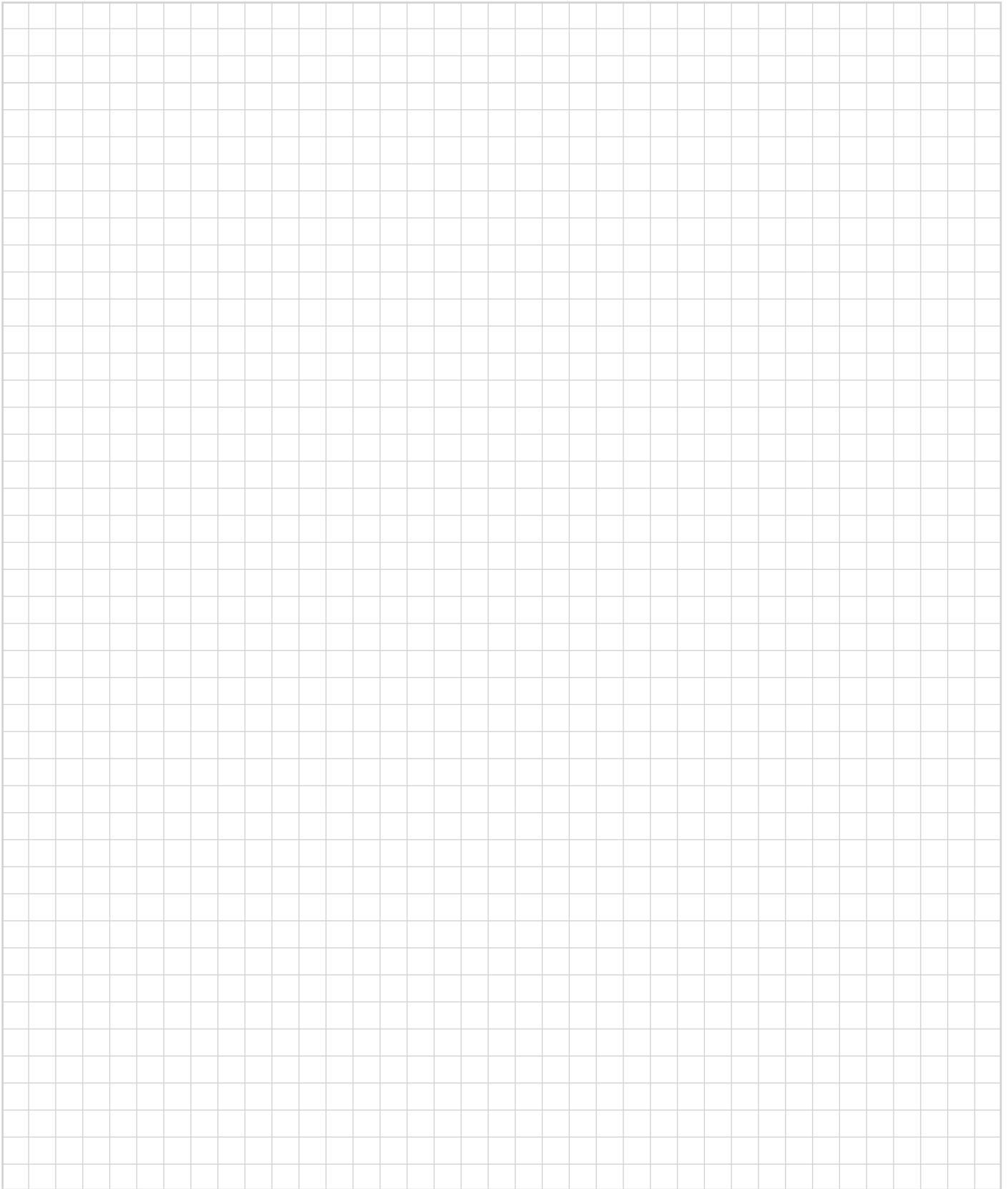

One thing is sure.



Gebr. Ostendorf Kunststoffe

